



AUCKLAND  
CONVENTIONS  
venues & events

# OUR VENUES

NEW ZEALAND'S  
LARGEST PORTFOLIO  
OF ICONIC VENUES



AUCKLAND  
CONVENTIONS  
venues & events

## CONTENTS

- 1 HAERE MAI & WELCOME
- 2 AOTEA CENTRE
- 4 AUCKLAND ART GALLERY TOI O TĀMAKI
- 6 AUCKLAND TOWN HALL
- 8 AUCKLAND ZOO
- 10 BRUCE MASON CENTRE
- 12 GO MEDIA STADIUM
- 14 MOTAT
- 16 NORTH HARBOUR STADIUM
- 18 SHED 10
- 20 THE CIVIC
- 22 THE CLOUD
- 24 VIADUCT EVENTS CENTRE
- 26 VENUE LOCATION MAPS
- 28 OUR SERVICES

*Haere mai*

WELCOME

TO AUCKLAND CONVENTIONS, VENUES & EVENTS

---

As custodians of New Zealand's largest portfolio of iconic venues, we are proud to offer a range of unique world-class venues for extraordinary events in Auckland.

Facilitating and delivering exceptional events is our passion. Whether your meeting, conference, exhibition, gala dinner or awards ceremony is for 50 or 2,000 people, choose from more than sixty versatile spaces to suit any occasion.

With a specialised and dedicated team, every detail is looked after with care to ensure the seamless delivery of each event.

Tātaki  
Auckland  
Unlimited 



# AOTEA CENTRE | AOTEA - TE POKAPŪ

AUCKLAND  
CONVENTIONS  
venues & events



## A FLEXIBLE MULTI-PURPOSE CONVENTION CENTRE

Situated in the heart of Auckland's central business district and creative hub, is the Aotea Centre - a leading, purpose-built performing arts and convention centre. Located a short walk from hotels, entertainment, shopping, dining and a major transport hub and educational institutions.

With multiple function rooms and spaces, it is the ideal location for conferences, exhibitions, award ceremonies, cocktail parties and gala dinners.

### FEATURES

- Conveniently located on Queen Street
- Auditorium seating for over 2,000
- Flexible spaces to suit all event types
- Multiple breakout rooms
- Building boasts cutting edge technology
- Award winning catering providers
- Close proximity to The Civic, Auckland Town Hall, Aotea Square and Herald Theatre
- On-site car parking facilities
- Close to major transport routes

Discover Aotea Centre here.

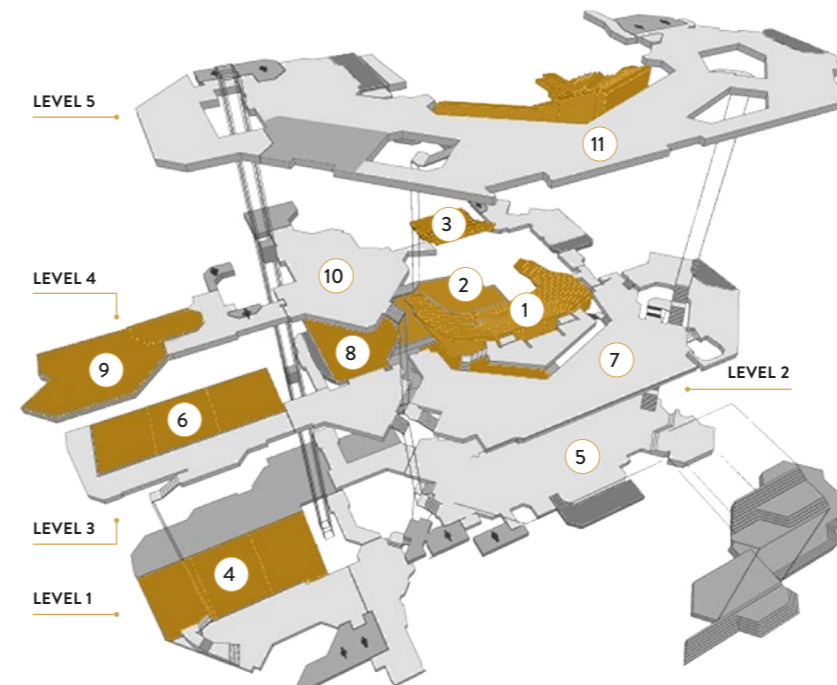

1. Kiri Te Kanawa Theatre



4. Hunua Rooms



6. Waitakere Rooms

### Capacity Chart

ROOMS	HEIGHT m	AREA m <sup>2</sup>	THEATRE	CLASSROOM	U-SHAPE	CABARET	BANQUET	COCKTAIL	EXHIBITION
Kiri Te Kanawa Theatre 1	—	—	2139	—	—	—	—	—	—
Kiri Te Kanawa Stage 2	—	—	—	—	—	—	160	300	—
Herald Theatre 3	—	—	186	—	—	—	—	—	—
Hunua Rooms including foyers   Level 1	4.35m	909m <sup>2</sup>	778	376	—	464	580	900	32
Hunua Rooms excluding foyers 4	4.35m	571m <sup>2</sup>	528	284	80	304	380	570	—
Hunua 1	4.35m	204m <sup>2</sup>	186	92	44	112	120	200	—
Hunua 2	4.35m	187m <sup>2</sup>	185	88	40	104	120	180	—
Hunua 3	4.35m	180m <sup>2</sup>	169	88	40	96	110	180	—
Stalls Foyer   Level 2 5	2.97m	800m <sup>2</sup>	—	—	—	—	—	800	20
Waitakere Rooms including foyers   Level 3	2.70m	518m <sup>2</sup>	440	264	—	280	330	500	18
Waitakere Rooms excluding foyers 6	2.70m	368m <sup>2</sup>	322	196	64	200	240	370	—
Waitakere 1	2.70m	137m <sup>2</sup>	128	60	36	72	90	140	—
Waitakere 2	2.70m	125m <sup>2</sup>	105	56	32	56	70	125	—
Waitakere 3	2.70m	106m <sup>2</sup>	97	40	32	48	60	100	—
Circle Foyer   Level 3 7	4.97m	460m <sup>2</sup>	—	—	—	—	—	460	22
Limelight Rooms   Level 3 8	2.50m	318m <sup>2</sup>	180	108	48	120	150	300	10
Limelight 1	2.50m	125m <sup>2</sup>	84	60	32	56	70	125	—
Limelight 2	2.50m	193m <sup>2</sup>	126	64	40	80	100	190	—
Waihorotiu 1   Level 4 9	2.68m	180m <sup>2</sup>	100	60	36	80	90	180	—
Waihorotiu 2   Level 4	2.40m	40m <sup>2</sup>	25	20	16	16	20	40	—
QBE Gallery   Level 4 10	2.50m	240m <sup>2</sup>	—	—	—	—	—	200	10
Balcony Foyer   Level 5 11	2.98m	1100m <sup>2</sup>	—	—	—	—	—	1000	42

Please note: All capacities are guidelines only and are based on the maximum use of the space available for standard setups. They may be reduced by staging, technical equipment, dance floors, type of menu being served or entertainment.



# AUCKLAND ART GALLERY TOI O TĀMAKI

AUCKLAND  
CONVENTIONS  
venues & events



## TRANSFORM YOUR EVENT INTO A MASTERPIECE

Combining modern and heritage architecture, Auckland Art Gallery Toi o Tāmaki is home to more than 18,000 works of art. Transform your gala dinner, cocktail function or auditorium presentation into a masterpiece at one of the city's most awe-inspiring settings. Situated on the edge of Albert Park, this award-winning heritage building seamlessly merges historical features with vibrant contemporary spaces, creating a unique and enchanting atmosphere for your event.

### FEATURES

- Located in the heart of Auckland city
- Celebrated mix of modern and heritage architecture
- Award winning catering providers
- Walking distance to a range of accommodation
- Perfect choice for weddings and corporate functions
- Paid parking facilities within walking distance
- Option to include exclusive viewings of selected exhibitions

Discover **Auckland Art Gallery Toi o Tāmaki** here.

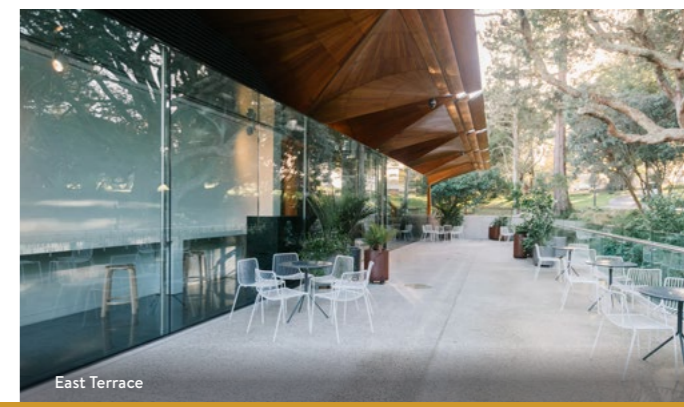
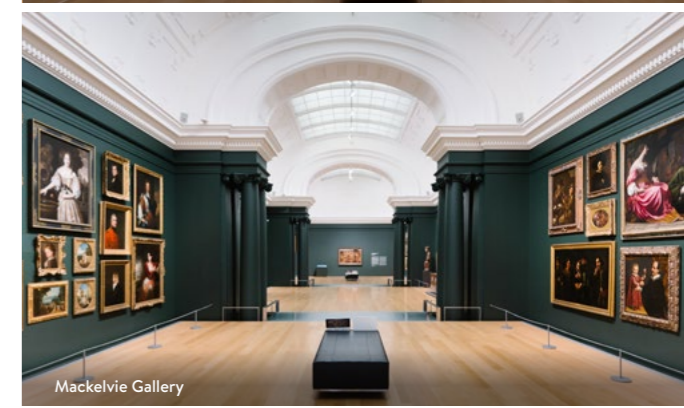
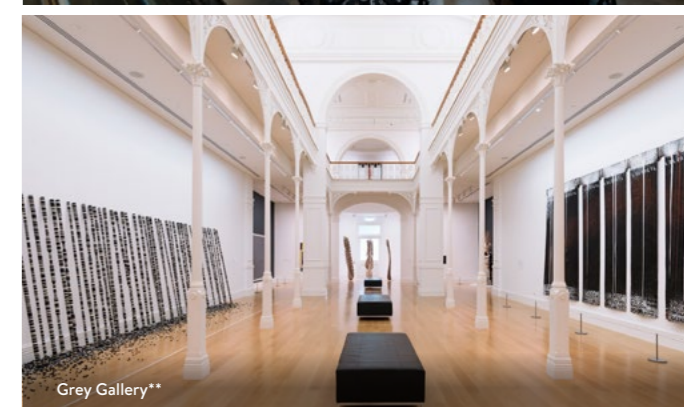
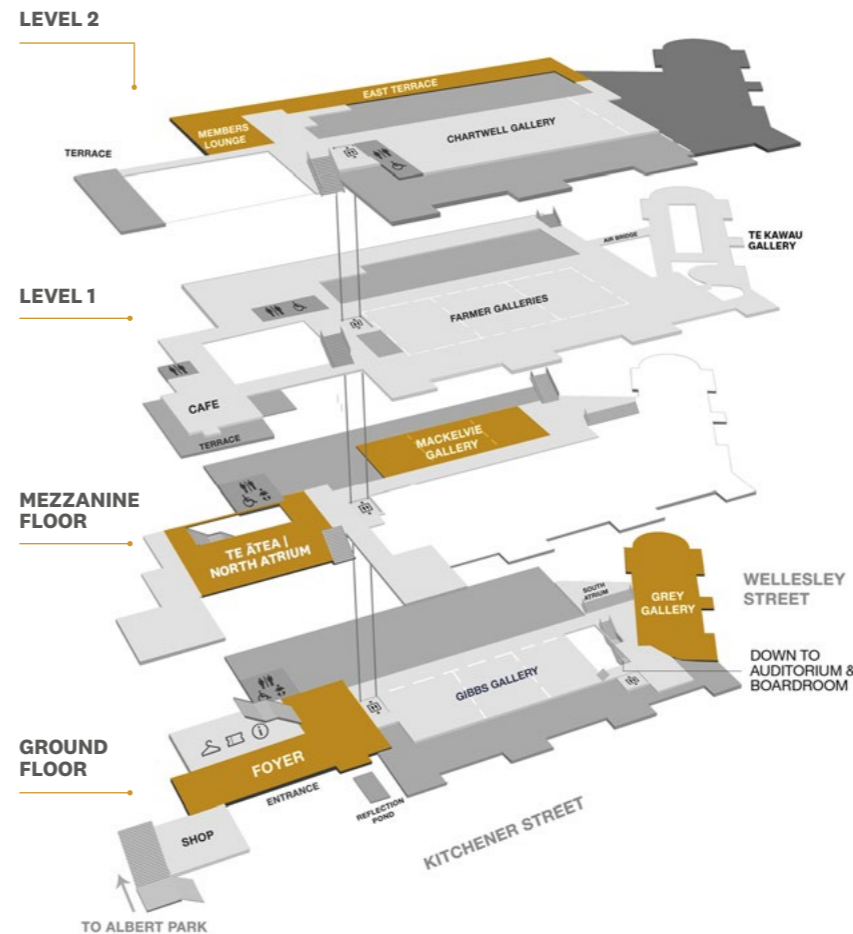

### Capacity Chart

ROOMS	HEIGHT m	AREA m <sup>2</sup>	THEATRE	BANQUET	COCKTAIL	BOARDROOM
Te Ātea   North Atrium*	Varied	243m <sup>2</sup>	160	130	250	-
Auditorium	Varied	-	150	-	-	-
Grey Gallery*	Varied	220m <sup>2</sup>	80	80	120	-
Mackelvie Gallery*	Varied	270m <sup>2</sup>	105	110	120	-
Boardroom	-	50.4m <sup>2</sup>	30	-	-	16
East Terrace*	-	325m <sup>2</sup>	-	-	250	-

Please note: All capacities are guidelines only and are based on the maximum use of the space available for standard setups.

They may be reduced by staging, technical equipment, dance floors, type of menu being served or entertainment.

\*Available for evening hire only.

\*\* Taimoana | Coastlines: Art in Aotearoa, Auckland Art Gallery Toi o Tāmaki, 2024.



# AUCKLAND TOWN HALL | HŌRO Ā-TĀONE O TĀMAKI MAKAURAU

AUCKLAND CONVENTIONS venues & events



## LAVISH INTERIORS FOR ELEGANT EVENTS

As one of New Zealand's most important heritage buildings, Auckland Town Hall is a stunning backdrop for any event with its attractive stained-glass windows, ornate plasterwork and spectacular chandeliers. Built in 1911 and home to New Zealand's largest concert organ, this landmark building was restored in the 1990s with event use in mind.

### FEATURES

- Significant heritage building
- Central Auckland City location
- Close proximity to Aotea Centre, Aotea Square and The Civic
- Stunning Edwardian Baroque design
- Renowned for excellent acoustics
- Theatre quality technical facilities on-site
- Perfect for gala dinners, exhibitions, cocktail functions, award ceremonies and school balls

Discover Auckland Town Hall here.

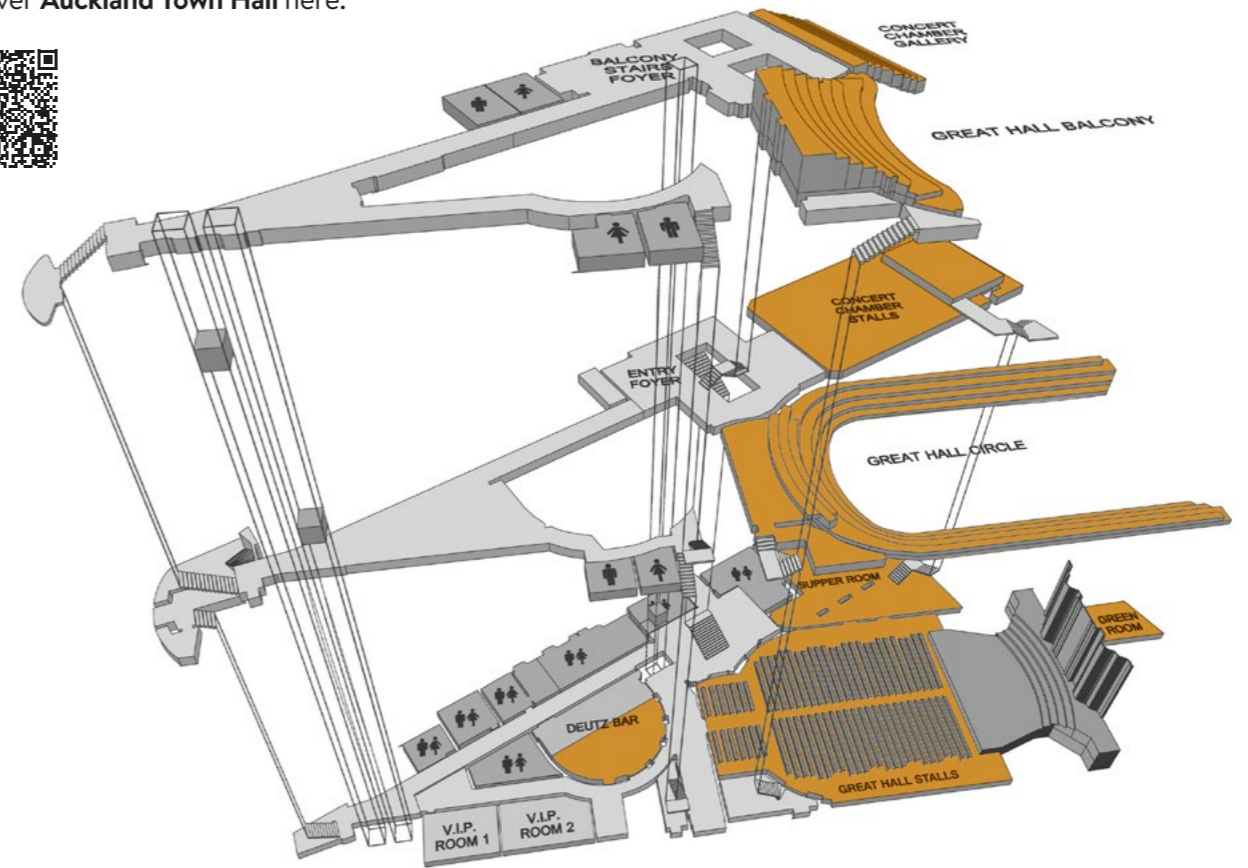

### Capacity Chart

ROOMS	HEIGHT m	AREA m <sup>2</sup>	THEATRE	CLASSROOM	CABARET	BANQUET	COCKTAIL	EXHIBITION
Great Hall	16m	550m <sup>2</sup>	1529	272	288	360	670	40 booths
Supper Room	4.15m	275m <sup>2</sup>	167	—	—	—	250	—
Deutz Bar	3.93m	105m <sup>2</sup>	—	—	—	—	150	—
Concert Chamber	9.7m	375m <sup>2</sup>	419	160	160	200	300	20 booths
Balcony Foyer	5.3m	—	—	—	—	—	200	—

Please note: All capacities are guidelines only and are based on the maximum use of the space available for standard setups. They may be reduced by staging, technical equipment, dance floors, type of menu being served or entertainment.



# AUCKLAND ZOO | TE WHARE KARAREHE O TĀMAKI MAKĀURAU

AUCKLAND  
CONVENTIONS  
venues & events



## EXPERIENCE A VENUE LIKE NO OTHER

With Aotearoa New Zealand's largest home of native and exotic wildlife as a backdrop, Auckland Zoo's distinctive function spaces make for memorable events, cocktail functions, seated dinners, team building events and more.

All events booked at Auckland Zoo support the important wildlife conservation efforts through Auckland Zoo's Conservation Fund.

### FEATURES

- Access to explore the Zoo on the day of your event
- Distinctive and flexible spaces
- Located close to the motorway and Auckland CBD
- Available for day and evening bookings
- On-site parking available
- Award winning catering providers



Discover Auckland Zoo here.



Old Elephant House



The Domes



The Domes



Old Elephant House Courtyard

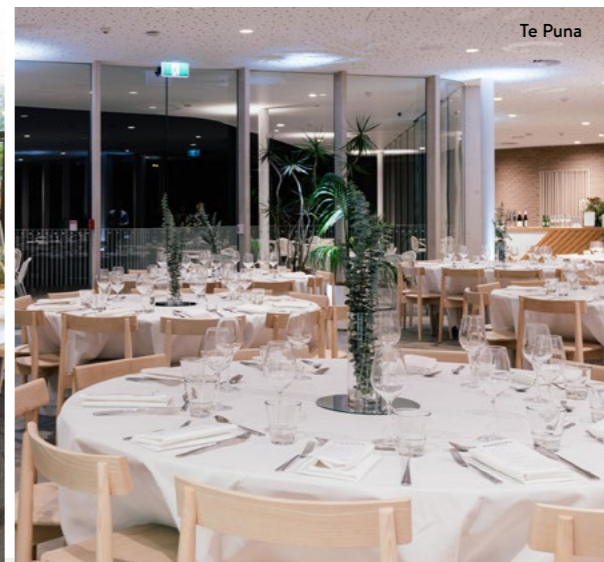

Te Puna



Cotton Top Tamarin Shelter

### Capacity Chart

ROOMS	HEIGHT m	AREA m <sup>2</sup>	THEATRE	CLASSROOM	CAFE	CABARET	BANQUET	COCKTAIL
The Domes	Varied	740m <sup>2</sup>	350	—	—	280	350	500
Te Puna*	150m	80m <sup>2</sup>	150	130	—	120	150	250
Old Elephant House with Courtyard*	—	170m <sup>2</sup>	—	—	120	—	—	160
Old Elephant House Courtyard**	—	70m <sup>2</sup>	50	30	50	—	50	80
Cotton Top Tamarin Shelter ***	—	Varied	40	—	—	—	—	60

Please note: All capacities are guidelines only and are based on the maximum use of the space available for standard setups. They may be reduced by staging, technical equipment, dance floors, type of menu being served or entertainment.

\* Available for evening hire only \*\* Available for day hire only \*\*\*Available for wedding ceremonies and pre-function cocktails for evening hire only



# BRUCE MASON CENTRE

AUCKLAND CONVENTIONS venues & events



## VERSATILE VENUE AT A TRANQUIL BEACHSIDE LOCATION

Conveniently located in central Takapuna, Bruce Mason Centre is a short walk from a selection of restaurants, shops, accommodation and the stunning Takapuna Beach.

With a theatre, break out rooms and two spacious foyers on offer, the venue can cater for conferences, cocktail evenings, product launches and flat-floor gala dinners in the theatre.

### FEATURES

- Theatre with tiered seating
- Theatre transforms for dramatic gala dinners
- Tranquil beach side location
- Escape the hustle and bustle of the city
- Only 15 minutes from Auckland's city centre

Discover Bruce Mason Centre here.

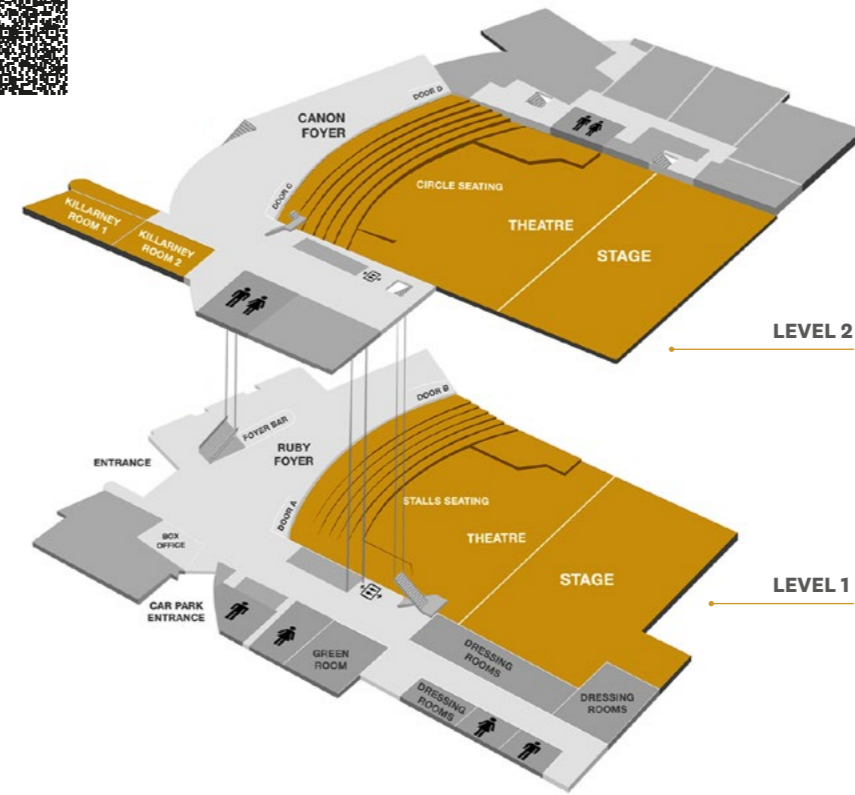

### Capacity Chart

ROOMS	HEIGHT m	AREA m <sup>2</sup>	THEATRE	CLASSROOM	U-SHAPE	CABARET	BANQUET	COCKTAIL	EXHIBITION
Theatre Stalls & Circle	—	—	1070	—	—	—	—	—	—
Flat Floor & Terraces	—	1200m <sup>2</sup>	—	—	—	—	406	820	—
Killarney Room 1	3m	75m <sup>2</sup>	52	24	15	24	30	50	4
Killarney Room 2	3m	51m <sup>2</sup>	40	15	9	16	20	30	2
Killarney Room 1 & 2	3m	126m <sup>2</sup>	84	36	—	48	50	90	7
Ruby Ormiston Foyer	—	350m <sup>2</sup>	—	—	—	—	—	350	8
Cannon Gallery	—	200m <sup>2</sup>	—	—	—	—	—	150	6

Please note: All capacities are guidelines only and are based on the maximum use of the space available for standard setups. They may be reduced by staging, technical equipment, dance floors, type of menu being served or entertainment.



# GO MEDIA STADIUM

AUCKLAND  
CONVENTIONS  
venues & events

Discover Go Media Stadium here.

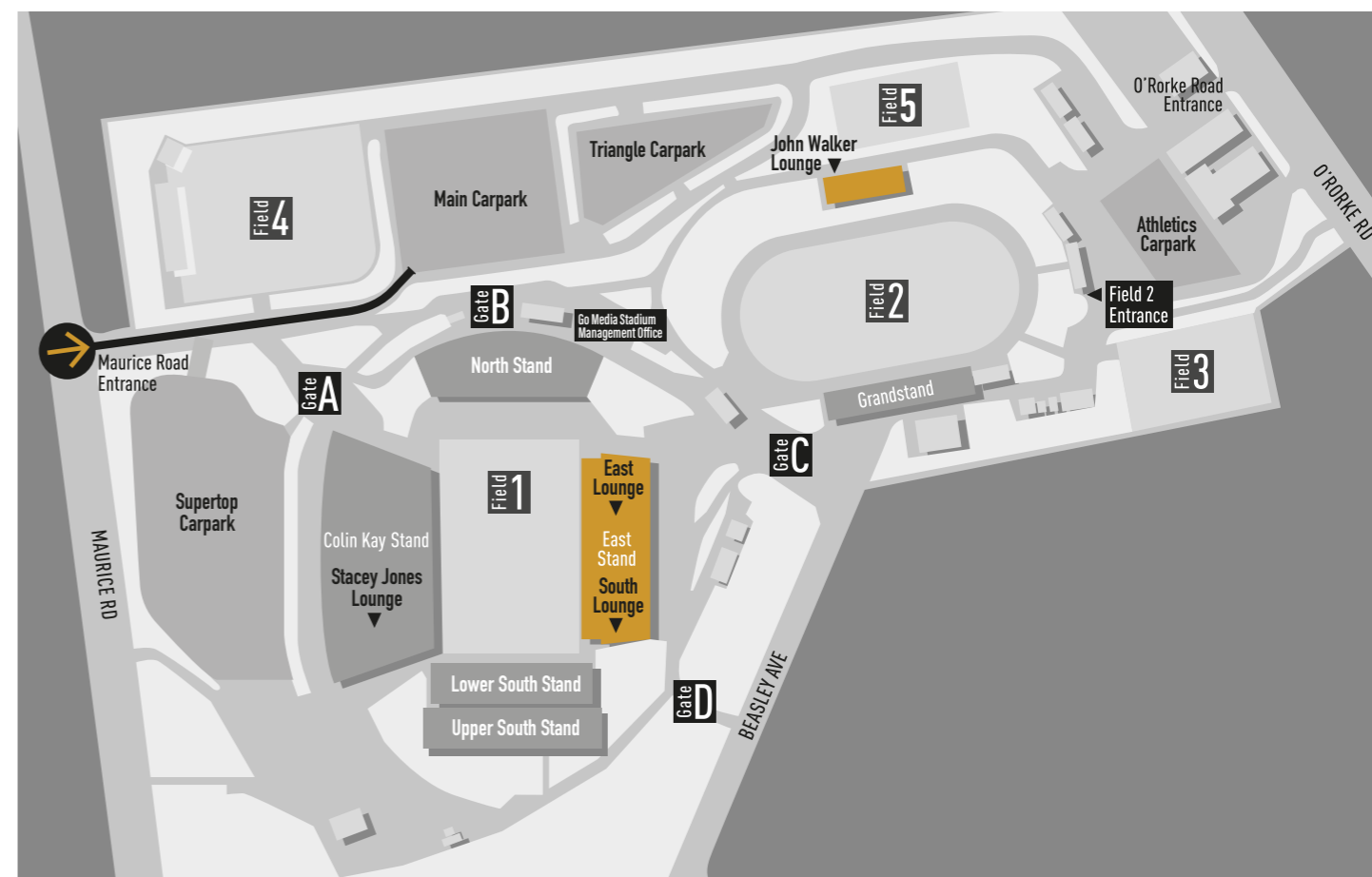

## A DISTINCTIVE BACKDROP FOR YOUR NEXT EVENT

Renowned for its world-class concerts, sporting and athletic events, Go Media Stadium also offers flexible spaces for truly unique business and social events. Easily accessible from the motorway and a 15 minutes drive from Auckland's city centre, Go Media Stadium is a convenient option on the outskirts of Auckland City. Spaces within Go Media Stadium offer the perfect blank canvas for cocktail functions, gala dinners, conferences and more.

### FEATURES

- Unique sporting atmosphere
- Impressive views over playing fields
- On-site parking facilities
- Close to major transport routes
- Plenty of natural light
- 3kms to Auckland Airport
- Flexible spaces to suit all event types
- Located in Penrose

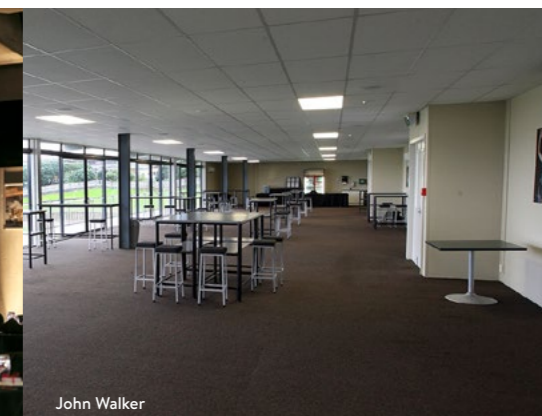
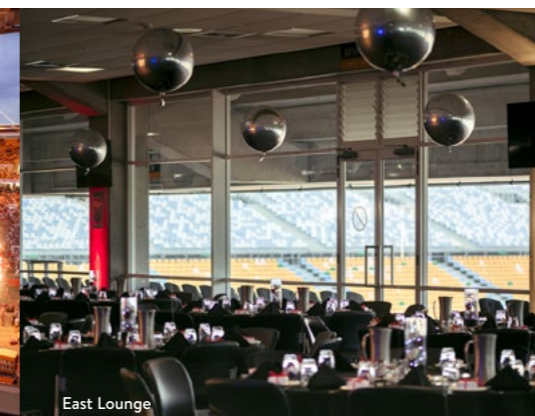

### Capacity Chart

ROOMS	HEIGHT m	AREA m <sup>2</sup>	THEATRE	CLASSROOM	CABARET	BANQUET	COCKTAIL	EXHIBITION
Full East Lounge (East & South Lounges)	3.5m	1257m <sup>2</sup>	900	336	520	650	1000	87 booths
East Lounge	3.5m	945m <sup>2</sup>	700	240	400	480	700	—
South Lounge	3.5m	312m <sup>2</sup>	200	84	160	200	300	—
John Walker Lounge	2.7m	311m <sup>2</sup>	250	60	152	190	250	—

Please note: All capacities are guidelines only and are based on the maximum use of the space available for standard setups. They may be reduced by staging, technical equipment, dance floors, type of menu being served or entertainment.



# MOTAT AVIATION HALL

AUCKLAND CONVENTIONS venues & events

Discover MOTAT's Aviation Hall here.



## THE ULTIMATE BACKDROP FOR YOUR EVENT

Taiwhanga Rererangi - Aviation Hall at MOTAT is home to one of the world's most unique aircraft collections. This stunning venue is located at Te Wai Ōrea Western Springs and can host cocktail events, award ceremonies, gala dinners and more. Welcome your guests under the nose of the Avro Lancaster Bomber, dine beneath the Solent and Sunderland flying boats and finish the evening taking in the spectacular view of the aircraft collection.

### FEATURES

- Houses a significant aircraft collection
- Distinctive and flexible space
- Award winning catering providers
- Available for evening hire only
- On-site parking available
- Located close to the motorway and Auckland CBD



### Capacity Chart

ROOMS	HEIGHT m	AREA m <sup>2</sup>	BANQUET	COCKTAIL
Aviation Hall	Varied	425m <sup>2</sup>	350	500

Please note: All capacities are guidelines only and are based on the maximum use of the space available for standard setups. They may be reduced by staging, technical equipment, dance floors, type of menu being served or entertainment.



# NORTH HARBOUR STADIUM

AUCKLAND CONVENTIONS venues & events

Discover North Harbour Stadium here.

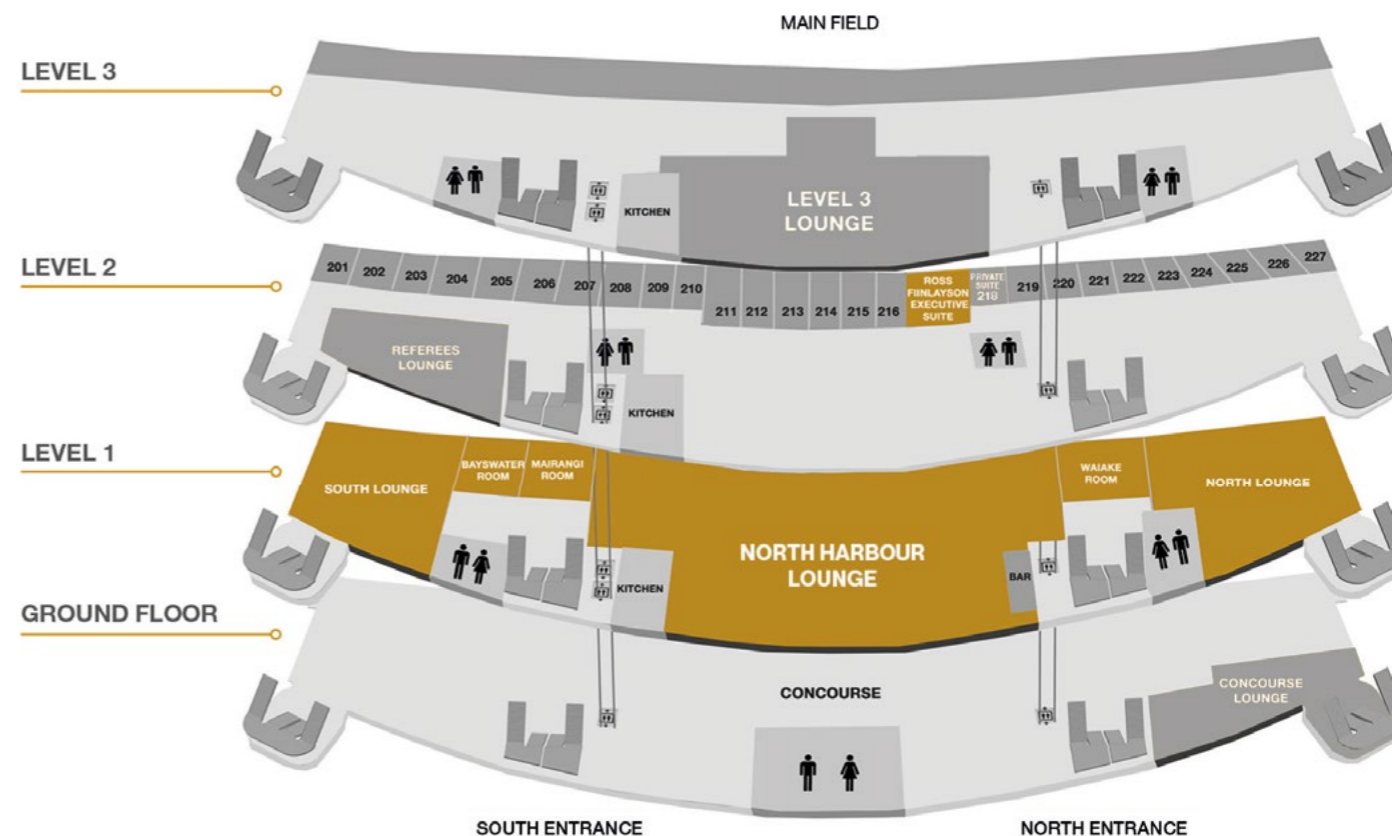

## A VERSATILE VENUE FOR YOUR NEXT EVENT

Located in Albany on Auckland's North Shore, North Harbour Stadium seamlessly merges sporting excellence with unparalleled event hosting capabilities. It offers seven versatile function spaces spread across two levels. From intimate private suites to expansive rooms, it caters to events of all sizes and configurations. With convenient motorway access and ample on-site parking, it boasts convenience and accessibility.

### FEATURES

- 7 versatile spaces
- Floor to ceiling glass windows
- Views across the main stadium field
- Soundproof room dividers available on Level 1
- Cocktail function capacity for 1,000
- 1,200 free car parks available on-site
- Close to major transport routes
- Located in Albany, 30 mins from Auckland's CBD



### Capacity Chart

ROOMS	HEIGHT m	AREA m <sup>2</sup>	THEATRE	CLASSROOM	U-SHAPE	CABARET	BANQUET	COCKTAIL	EXHIBITION
North Harbour Lounge   Level 1	2.65m	974m <sup>2</sup>	697	207	—	368	500	1000	98
North Lounge   Level 1	2.65m	327m <sup>2</sup>	240	84	34	152	190	350	23
South Lounge   Level 1	2.65m	248m <sup>2</sup>	180	92	32	112	150	300	17
Bayswater & Mairangi Room   Level 1	2.65m	135m <sup>2</sup>	100	40	30	64	80	120	10
Bayswater Room   Level 1	2.65m	68m <sup>2</sup>	50	16	18	32	40	75	6
Mairangi Room   Level 1	2.65m	68m <sup>2</sup>	50	16	18	32	40	75	6
Waiake Room   Level 1	2.65m	68m <sup>2</sup>	50	16	18	32	40	75	6
Ross Finlayson Executive Suite   Level 2	2.32m	55m <sup>2</sup>	—	—	14	—	30	40	—

Please note: All capacities are guidelines only and are based on the maximum use of the space available for standard setups. They may be reduced by staging, technical equipment, dance floors, type of menu being served or entertainment.



# SHED 10

AUCKLAND  
CONVENTIONS  
venues & events

Discover Shed 10 here.

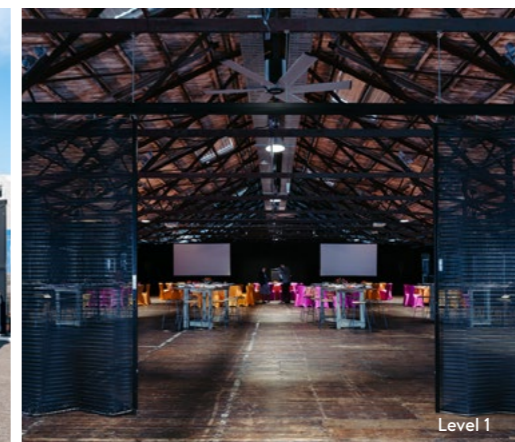
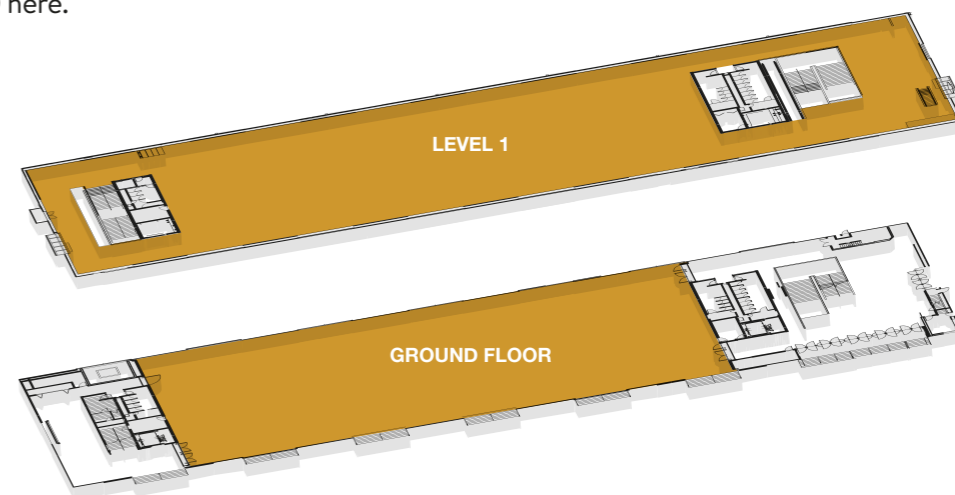

## A BLANK CANVAS TO MAKE YOUR OWN

Shed 10 is a 100-year-old cargo shed full of character and historical significance. Built in 1910, Shed 10 is the only remaining original building on Auckland's Queens Wharf. This heritage-listed building has undergone a thoughtful restoration, providing facilities for glamorous gala dinners and cocktail functions.

### FEATURES

- Located on Queens Wharf on the Auckland waterfront
- Uninterrupted views of the Waitematā Harbour
- 4,400m<sup>2</sup> over two levels
- Multipurpose event venue
- Walking distance from public transport hubs and retail precincts
- Close to multiple hotels and entertainment options

### Capacity Chart

ROOMS	HEIGHT m	AREA m <sup>2</sup>	THEATRE	CABARET	BANQUET	COCKTAIL	EXHIBITION
Ground Floor	4.9m	2216m <sup>2</sup>	1575	580	700	2000	61 booths
Level 1	3.75m	2204m <sup>2</sup>	1000	640	750	1000	53 booths

Please note: All capacities are guidelines only and are based on the maximum use of the space available for standard setups. They may be reduced by staging, technical equipment, dance floors, type of menu being served or entertainment.



# THE CIVIC | TE CIVIC

AUCKLAND  
CONVENTIONS  
venues & events

Discover **The Civic** here.



The Civic Foyer

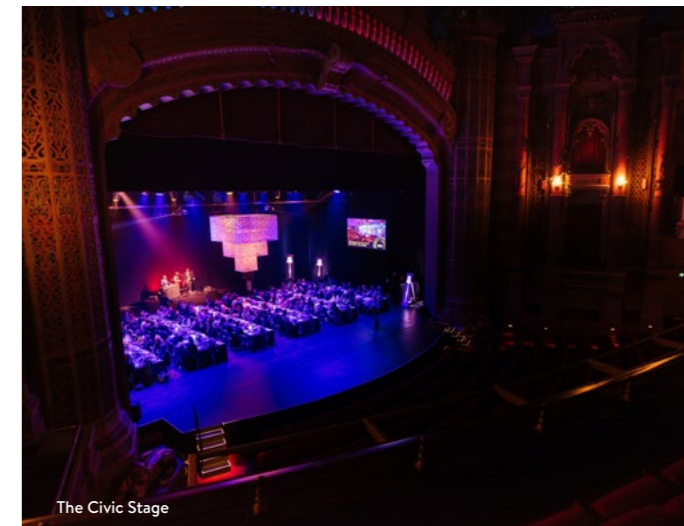

The Civic Stage



Wintergarden

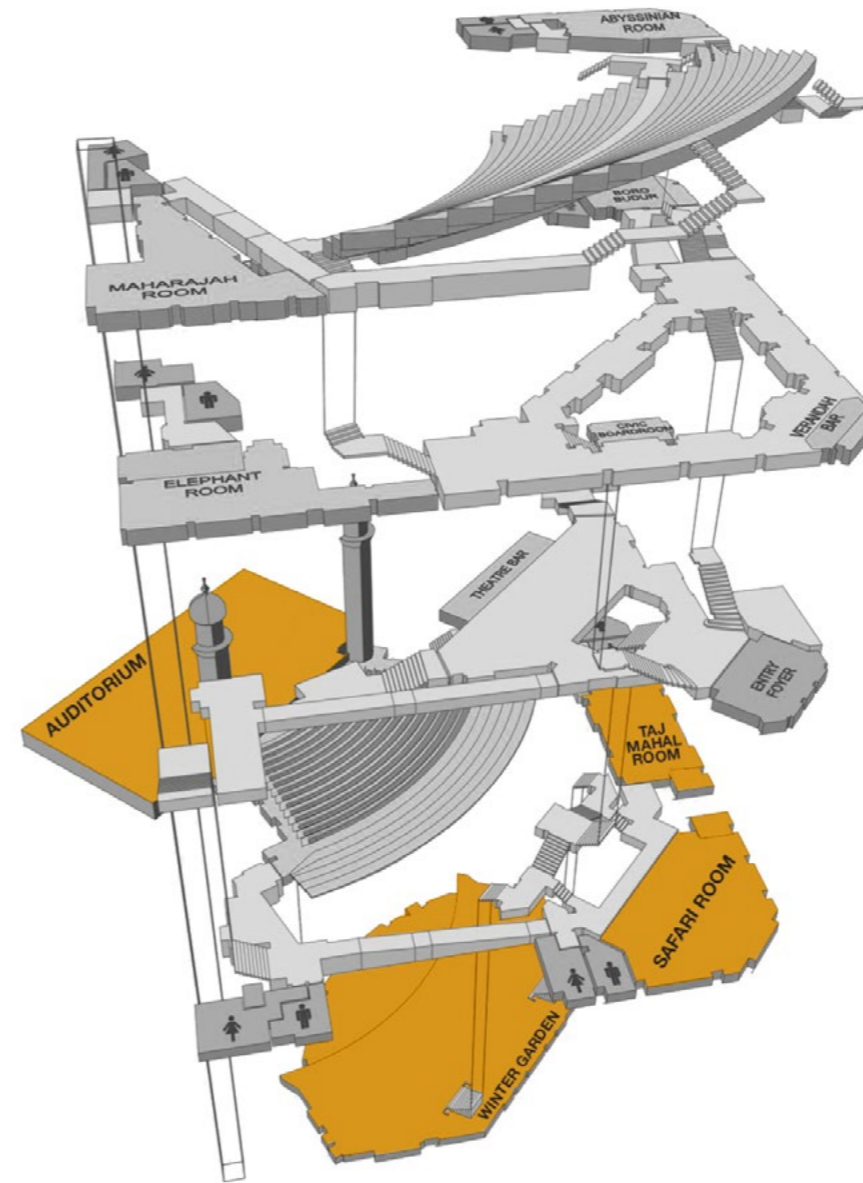

## OPULENCE IN THE HEART OF THE CITY

The Civic, a much-loved Auckland landmark and entertainment venue is one of the few remaining atmospheric theatres in the world. It is an opulent and dramatic venue with unique rooms for hire. Sweeping double staircases, smaller rooms and extensive circulation space around the ornate bars make The Civic well suited for intimate and large events like cocktail functions, banquet dinners, pre-show cocktails and more.

### FEATURES

- Central Auckland city location
- Domed ceiling with spectacular starscape
- Four unique spaces to choose from
- Moorish design with turrets, minarets and spires
- Award winning catering providers
- Ability to host an event on The Civic Auditorium Stage

### Capacity Chart

ROOMS	HEIGHT m	AREA m <sup>2</sup>	THEATRE	U-SHAPE	CLASSROOM	CABARET	BANQUET	COCKTAIL
The Civic Auditorium	24m	1990m <sup>2</sup>	2378	—	—	—	—	—
The Civic Stage	—	—	—	—	—	—	210	300
Wintergarden	4m	550m <sup>2</sup>	428	—	292	256	320	525
Safari Room	2.75m	160m <sup>2</sup>	70	28	40	64	80	80
Taj Mahal Room	4m	110m <sup>2</sup>	63	28	40	40	50	70

Please note: All capacities are guidelines only and are based on the maximum use of the space available for standard setups. They may be reduced by staging, technical equipment, dance floors, type of menu being served or entertainment.



# THE CLOUD

AUCKLAND  
CONVENTIONS  
venues & events

Discover **The Cloud** here.

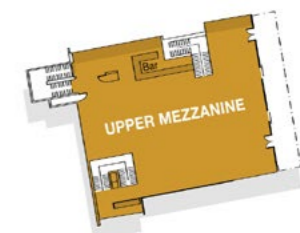

Level 2

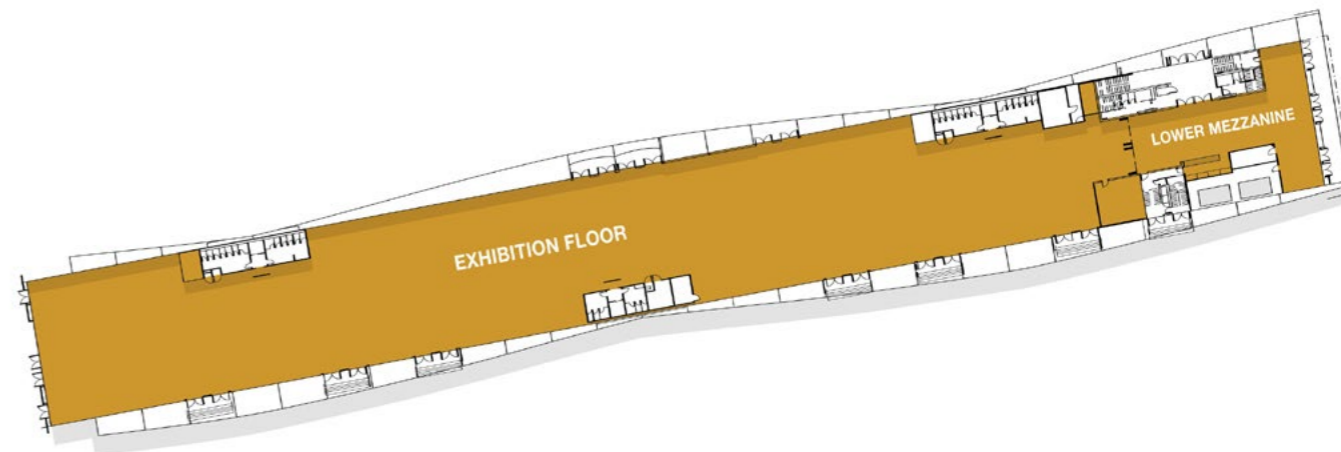

Level 1



Upper Mezzanine

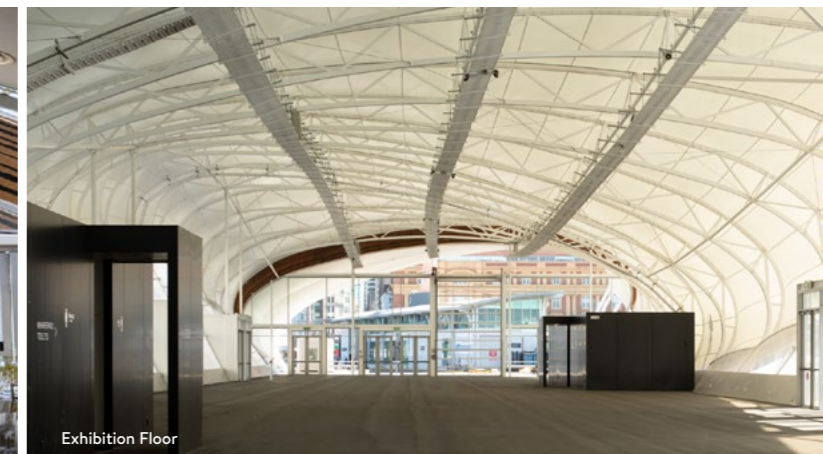

Exhibition Floor



Balcony



Lower Mezzanine

## EXQUISITELY UNIQUE ON QUEENS WHARF

The Cloud is a unique, modern structure along Auckland's waterfront. It is conveniently located close to hotels, shopping, dining and entertainment precincts. This multipurpose venue is ideal for exhibitions, cocktail functions, dinners, weddings and large-scale events. Most spaces offers unparalleled views of the Waitematā Harbour.

### FEATURES

- Unique and modern
- Pillar-less venue
- 2,700m<sup>2</sup> exhibition floor space
- Flexible spaces to suit all event types
- Award winning catering providers
- Close proximity to Shed 10 and downtown Auckland
- Walking distance from major transport hubs - train, bus and ferry terminals
- Panoramic views of Rangitoto Island and Devonport across the Waitematā Harbour

### Capacity Chart

ROOMS	HEIGHT m	AREA m <sup>2</sup>	THEATRE	BANQUET	COCKTAIL	EXHIBITION
Exhibition Floor	Varied	2697m <sup>2</sup>	2000	1750	2000	107
Lower Mezzanine	2.8m	228m <sup>2</sup>	100	100	100	8
Upper Mezzanine	Varied	444m <sup>2</sup>	230	190	230	11

Please note: All capacities are guidelines only and are based on the maximum use of the space available for standard setups. They may be reduced by staging, technical equipment, dance floors, type of menu being served or entertainment.



# VIADUCT EVENTS CENTRE

AUCKLAND CONVENTIONS venues & events



## A PREMIUM VENUE EXCEPTIONAL ON ALL LEVELS

The Viaduct Events Centre takes pride of place in Auckland's reinvigorated Wynyard Quarter. The building has been designed to a five-star environmental standard and makes the most of its impressive waterfront location with glass walls, balconies, and easy access to the wharf. This venue is ideal for cocktail functions, gala dinners, exhibitions, and conferences.

### FEATURES

- Distinctive and flexible spaces
- Located on the waterfront in the vibrant Wynyard Quarter
- 6,000m<sup>2</sup> three-storey venue
- Dramatic views across the Waitematā Harbour
- Premium banquet space
- Award winning catering providers
- On-site audio-visual technicians
- Seven versatile rooms
- Accessible balconies attached to Level 2 and 3 spaces

Discover Viaduct Events Centre here.

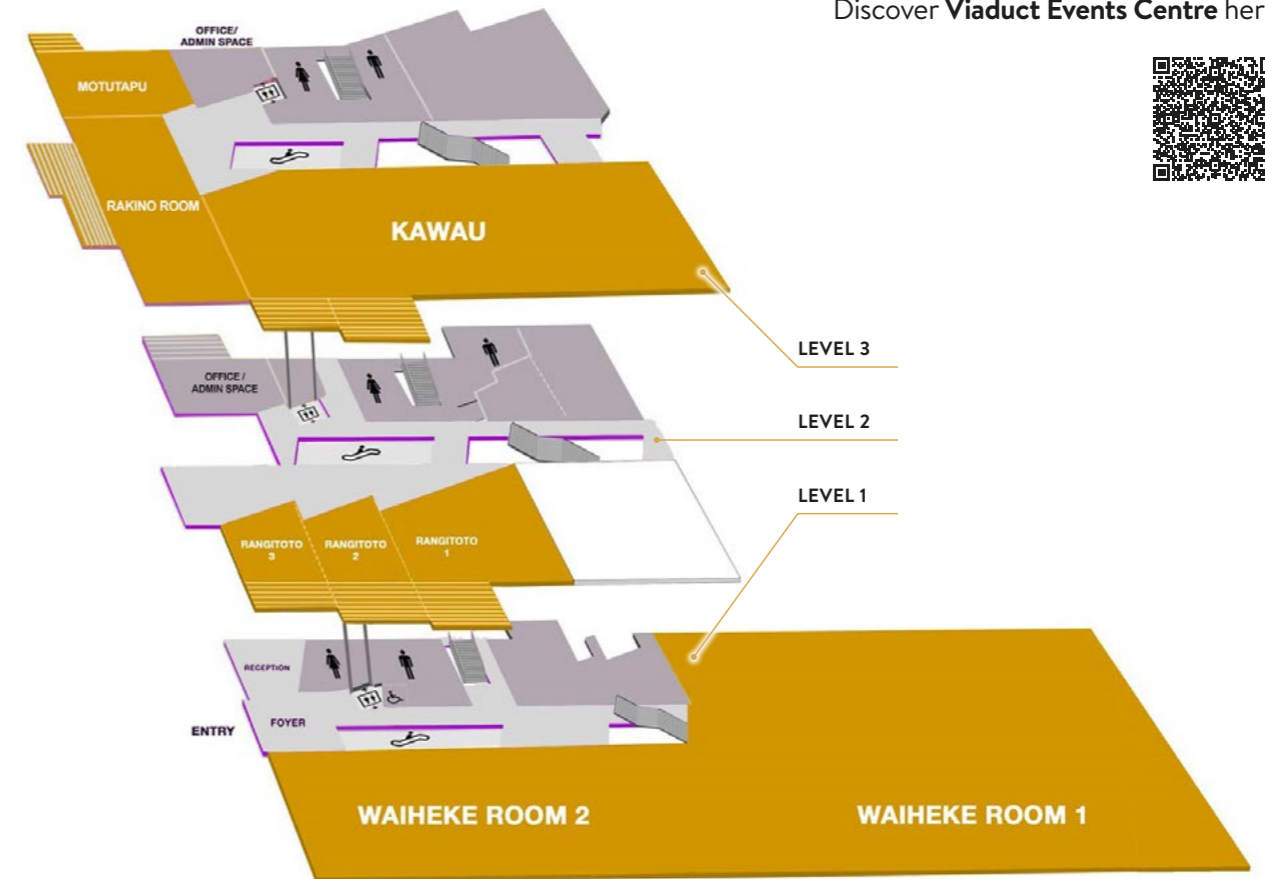

### Capacity Chart



ROOMS	HEIGHT m	AREA m <sup>2</sup>	THEATRE	CLASSROOM	BANQUET	COCKTAIL	EXHIBITION
Waiheke 1 & 2	Varied	2109m <sup>2</sup>	2300	1200	1200	2850	130 booths
Waiheke 1	12m	1406m <sup>2</sup>	1800	1000	850	2200	100 booths
Waiheke 2	3.5m	703m <sup>2</sup>	450	320	400	600	25 booths
Rangitoto 1	3.5m	192m <sup>2</sup>	180	96	120	240	–
Rangitoto 2	3.5m	74m <sup>2</sup>	50	40	50	50	–
Rangitoto 3	3.5m	72m <sup>2</sup>	50	32	50	50	–
Rangitoto 1 & 2	3.5m	267m <sup>2</sup>	–	–	–	240	–
Rangitoto 2 & 3	3.5m	146m <sup>2</sup>	–	–	–	175	–
Rangitoto 1, 2, 3	3.5m	338m <sup>2</sup>	–	–	–	240	–
Kawau	4m	570m <sup>2</sup>	570	375	400	700	30 booths
Motutapu	4m	88m <sup>2</sup>	50	48	50	50	–
Rakino	4m	192m <sup>2</sup>	180	100	120	200	–

Please note: All capacities are guidelines only and are based on the maximum use of the space available for standard setups. They may be reduced by staging, technical equipment, dance floors, type of menu being served or entertainment.



## CENTRAL AUCKLAND

KEY

-  Auckland Conventions' Venues
-  Accommodation
-  Parking Facilities



- Aotea Centre**  
50 Mayoral Drive, Auckland
- Auckland Art Gallery**  
Toi o Tāmaki  
Corner of Kitchener & Wellesley Streets, Auckland
- Auckland Town Hall**  
305 Queen Street, Auckland
- Shed 10**  
89 Quay Street, Auckland
- The Civic**  
Corner Queen Street & Wellesley Street, Auckland
- The Cloud**  
89 Quay Street, Auckland
- Viaduct Events Centre**  
161 Halsey Street, Wynyard Quarter

## WIDER AUCKLAND

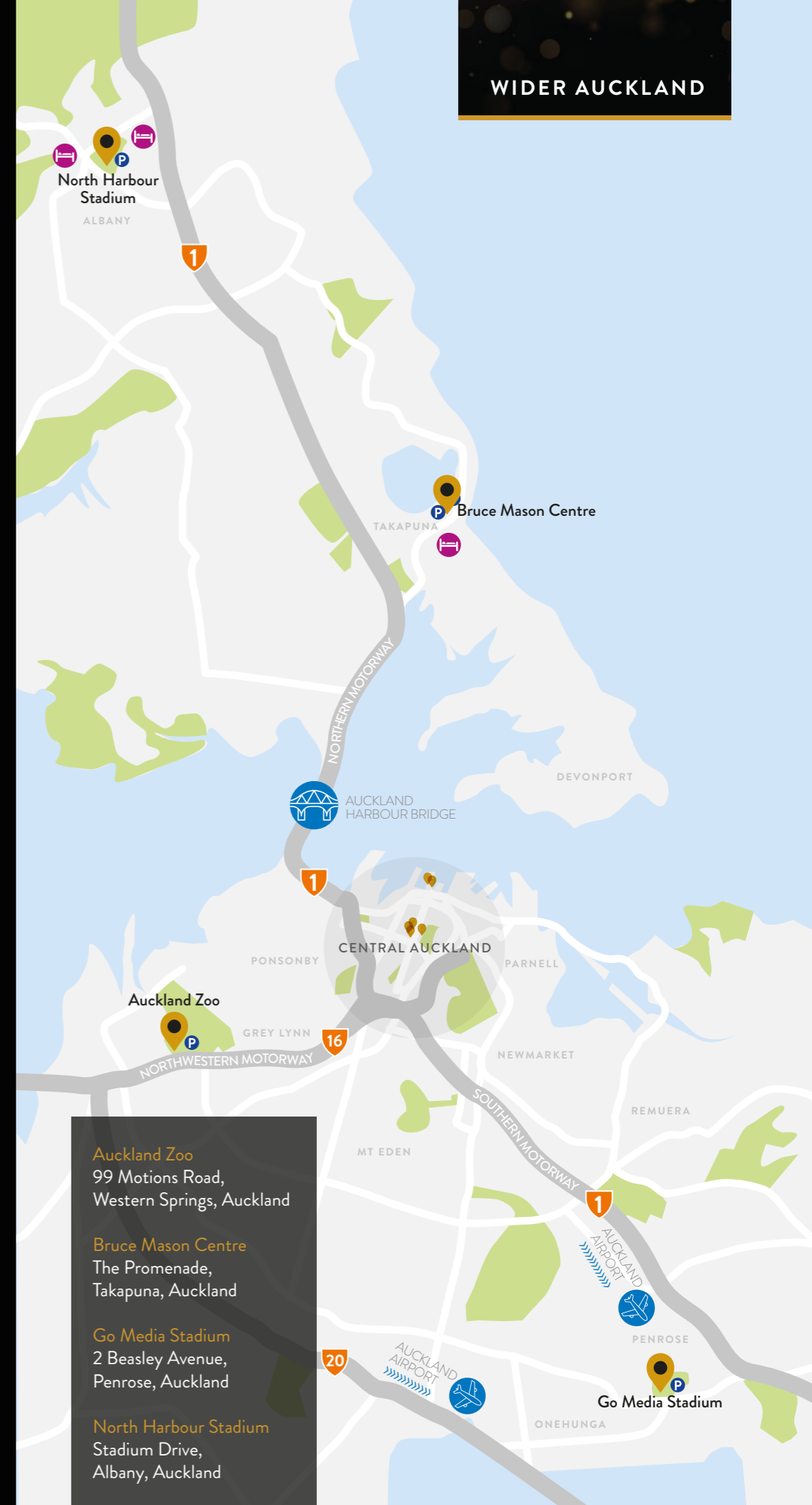

- Auckland Zoo**  
99 Motions Road, Western Springs, Auckland
- Bruce Mason Centre**  
The Promenade, Takapuna, Auckland
- Go Media Stadium**  
2 Beasley Avenue, Penrose, Auckland
- North Harbour Stadium**  
Stadium Drive, Albany, Auckland



# OUR SERVICES

With an experienced and specialised team, state-of-the-art facilities and equipment, and a comprehensive range of in-house services, Auckland Conventions is passionate about catering for every event requirement.

## EVENT PLANNING

A dedicated Event Planner is assigned to partner with you for every event. They are your point of contact for providing ideas, answering questions and looking after every detail to ensure the successful delivery of your event.

## TECHNICAL SERVICES

From lighting design to audio visual support, our technical team offers the experience and technical capability to turn your creative vision into reality.

## CATERING

We partner with some of Auckland's finest, award winning food and beverage specialists to create exceptional menus to suit your working lunch, cocktail function, gala dinner and more.

## SECURITY SERVICES

Our security services team ensures a safe and enjoyable environment is maintained throughout our venues and events, providing safety and security assistance where necessary.

### THIS PAGE

'Untitled' by Paratene Matchitt,  
Aotea Centre. Photo by Sacha Stejko.

### BACK COVER

The Civic. Photo by David Straight.

### IMAGE PHOTOGRAPHY

Michael Bradley, Jinki Cambroner, Jay Farnworth,  
Caren Hastings, Tom Hollow, Heath Johnson /  
Deft Photography, Ivan Muller, Murray Lloyd Photography, Hannah  
Peters, David St George, Bas van Est, David Watson, David Straight.

*Nga mihi*





**NEW ZEALAND'S LARGEST PORTFOLIO OF ICONIC VENUES**

Level 4, Aotea Centre, 50 Mayoral Drive, Auckland 1010, New Zealand  
PO Box 5749, Victoria Street West, Auckland 1142, New Zealand

**T** 0800 54 98 98 | +64 9 309 2677 | 1800 54 98 98 (AUST)

**E** [events@aucklandconventions.co.nz](mailto:events@aucklandconventions.co.nz)

**W** [aucklandconventions.co.nz](http://aucklandconventions.co.nz)

**AUCKLAND  
CONVENTIONS**  
venues & events