

Now that you've explored our portraits, it's time to create your own! Draw a portrait of yourself, your family, friends or your pets in the frame.

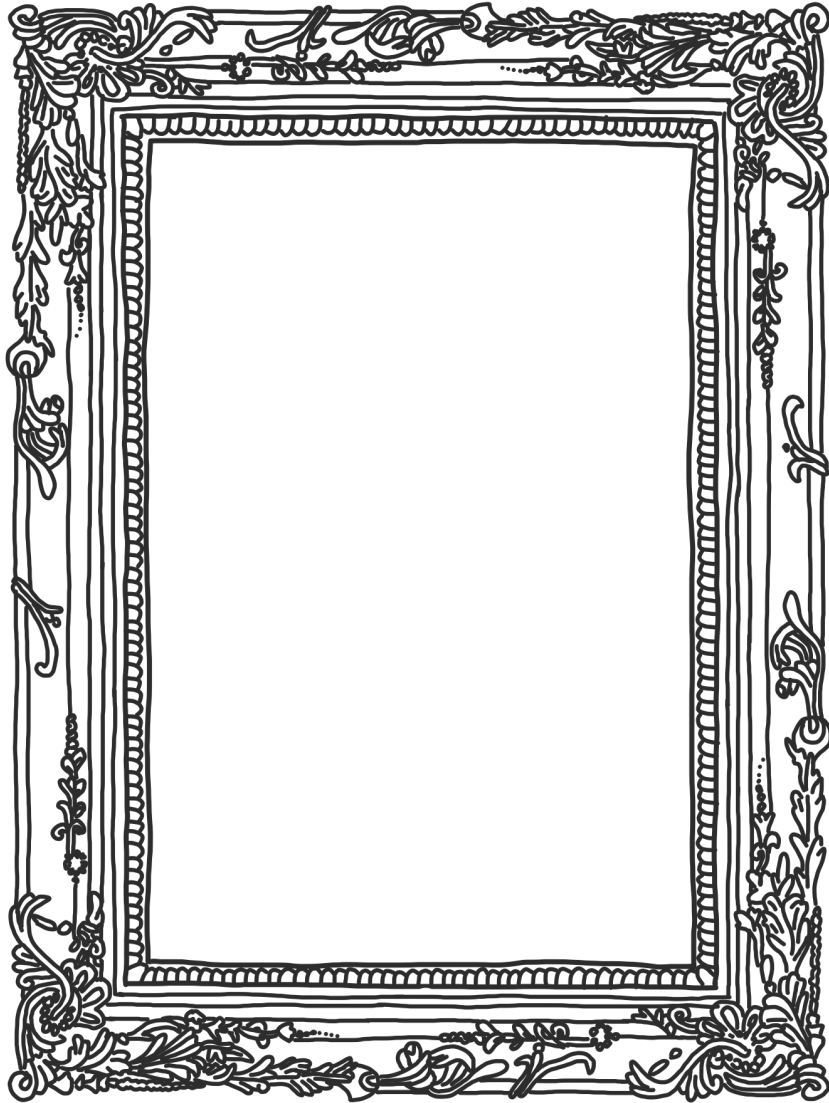

Portrait Explorer Activity



Can you find me...

There are many portraits on display in the Ground level of the Gallery. Follow the colour-coded clues to find out who is in each portrait and learn more about them.

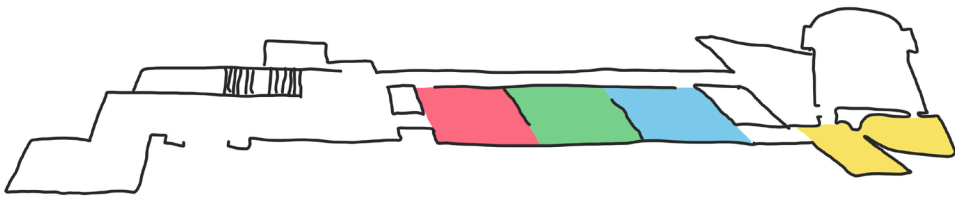

- 9 I am a different sort of self-portrait. I am a vessel from which water is poured. I look a bit startled with my eyes wide and mouth open. Can you find me surrounded by other objects? If you were an object what might you be? Draw it below.

Artwork title: _____

- 8 We are a group of men who look a bit different. We were all famous and well-known New Zealanders in our time. We have been painted holding all sorts of different items, like paint palettes and umbrellas. Once you find us, take a close look. **Draw yourself (or someone you are with) in the same style.**

Artwork title: _____

- 1 I was rangatira (chief) of Ngāti Hako and Ngāti Tamatera, and a strong land activist in my time. I wear the puhoi (skin) of one of Aotearoa's extinct birds as a taonga whakarākei (body adornment) from my ear. **Draw the bird.**

Artwork title: _____

- 2 I was the prophet and founder of a church I called Hauhau (the breath of god). I based my church on the idea of Pai Mārire – goodness and peace. I was a supporter of the kingitanga (Māori king) movement, and baptised the second King Tāwhiao. I wear a kaitaka aronui (cloak) with a woven tāniko border. **Draw the patterns you see on the tāniko border.**

Artwork title: _____

- 7 I am staring straight at you from my portrait, wearing my wedding clothes. For many years art historians thought this portrait was of someone else, but the style of my large hat helped them figure out it was me. **Draw the hat I am wearing.**

Artwork title: _____

- 6** In 1863 I heroically swam out into stormy seas to save the ship *Delaware* and its crew. I swam out many times to try and save as many people as I could. This made me famous all around Aotearoa, and I was called 'Grace Darling' by many people. In my portrait, I wear a beautiful korowai (cloak) made of tūī, kākā, and kererū feathers. **Draw me and my korowai.**

Artwork title: _____

- 3** I was one of 14 Māori chiefs who travelled to England in 1863 where I met Queen Victoria. While there, I also married an English woman, Elizabeth Reid, who returned with me to Aotearoa. I wear a kaitaka aronui (cloak) wrapped around me and a tooth hanging from my ear. **Create your own version of my portrait.**

Artwork title: _____

4

I was a passionate, strong and proud leader. I was one of five women to sign Te Tiriti o Waitangi when it came to Kāpiti. I was a renowned speaker and composer, and wrote many waiata, poems and mōteatea (laments).

Draw the three hei tiki that hang around my neck.

Artwork title: _____

5

I was a famous guide of the Rotorua thermal area and the Pink and White Terraces. In 1886 while taking a group of tourists out on Lake Tarawera, I saw a phantom waka (canoe), which was thought to be an omen of disaster. Ten days later there was a volcanic eruption at Lake Tarawera. **What do you think a phantom waka would look like? Draw it here.**

Artwork title: _____