

**ART** AND  
GIVEN





Auckland Art Gallery Toi o Tāmaki



**Auckland Art Gallery Toi o Tāmaki  
– a steward of New Zealand  
and international culture**

---

Auckland Art Gallery Toi o Tāmaki sits at the edge of Albert Park in the heart of the CBD. An award-winning heritage building that blends history with contemporary flare, the Gallery's diverse architectural styles mean there is always a suitable and impressive space for your event.

The Gallery is the proud steward of more than 17,000 artworks, including national treasures and the strongest international art collection in New Zealand, and exhibits an ever-changing series of inspiring exhibitions drawn from our collections and from partners abroad.

Take your pick from our many diverse spaces and allow us to curate the perfect event for you and your guests. From product launches and weddings to film screenings, team conferences or yoga classes, there is no barrier to the type of events you can hold at the Gallery.

Hosting an event at Auckland Art Gallery is a unique opportunity for guests to step into one of the country's most beloved and respected cultural institutions.





North Atrium



## North Atrium

---

Added to the heritage building in 2011 and now the heart and hub of the Gallery, the North Atrium is our largest and most contemporary space. It allows flexibility in event design and hosting and can suit whatever you may have in mind. With views from and onto Kitchener Street, your event will truly be on show! We always have a commissioned contemporary artwork in the Atrium which adds to the uniqueness of your event. Please check in with our events coordinator to learn about the latest and forthcoming art installations.

This is a space your guests will never forget.

---

### Pax:

**Cocktail – 250**

**Banquet – 130**

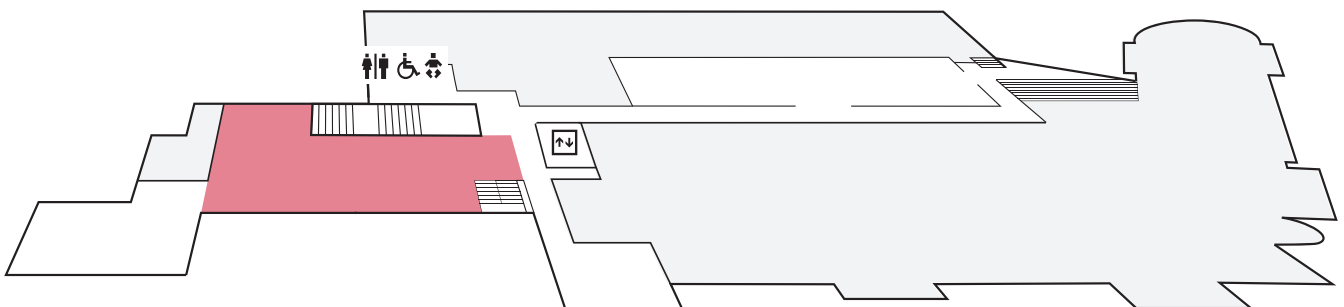

---

**Mezzanine**







## Mackelvie Gallery

---

This gallery space is named in honour of the late James Tannock Mackelvie, a Scotsman who made his wealth in New Zealand and who, in gratitude, donated his vast collection of artwork to the people of Auckland. The space is one of the oldest in the Gallery. Its new floor, part of the Gallery's redevelopment, floats above the original, providing a glimpse to the past and a point of interest. Enjoy the work of past European artists, as you host an event steeped in the history of art and architecture.

---

**Pax:**

**Cocktail – 120**

**Banquet – 80**

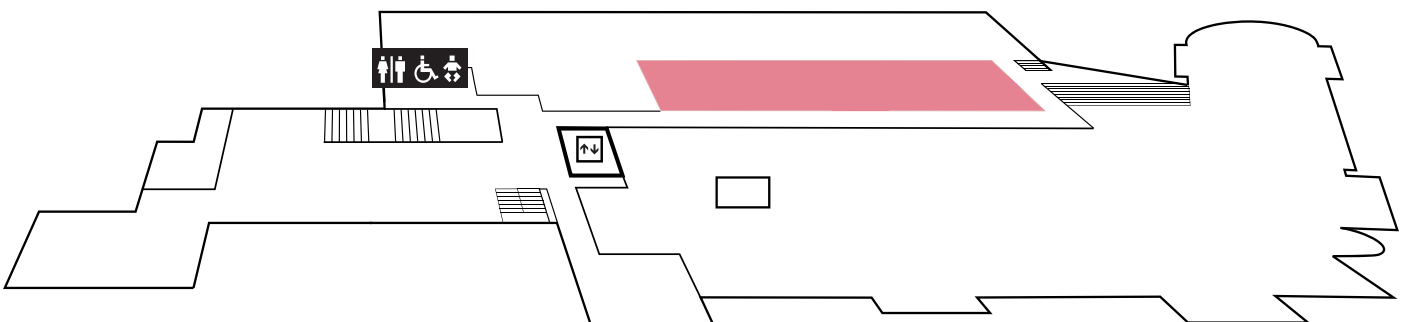

---

**Mezzanine**





East Terrace



## East Terrace

---

As the only outdoor hire space in the Gallery, the East Terrace is an ideal choice for a summer soirée. Sitting on the top floor and overlooking Albert Park, the Terrace feels private and exclusive. Its modern architecture and generous square meterage allow for substantial hosting possibilities. By hiring the Members lounge in addition you'll enjoy the exclusive option of an indoor VIP area.

The East Terrace is occasionally used as a display space for artworks. Check in with the events coordinator for its status in this regard.

---

### Pax:

**Cocktail – 350**

**Banquet – 150**

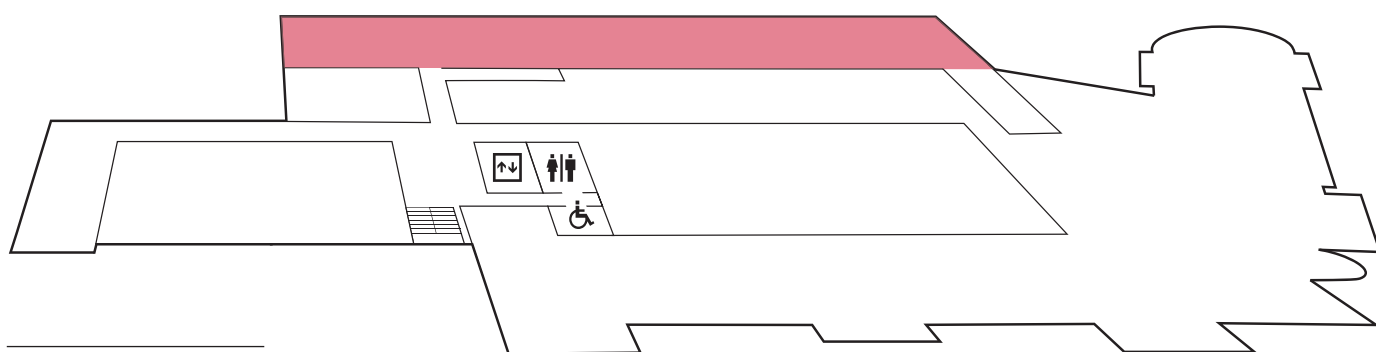

---

Level 2



Lower Grey Gallery



Originally the Auckland City Library and now a spectacular home to exhibitions of New Zealand art, the Lower Grey Gallery is the building's oldest venue space and full of our cultural heritage. A popular choice for weddings, its light-coloured balustrades and double-storey ceiling create stunning sightlines and a sense of grandeur. The walls of the Lower Grey Gallery are often adorned with works from our exceptional collection of New Zealand modern art, so expect to be surrounded by some of the best artworks made in this country.

## Ground





Members Lounge



## Members Lounge

---

Constructed for the exclusive use of Gallery Members, we have now opened up this beautiful space for evening hire. The lounge can be used for a multitude of events, including a team away day. There is a mini kitchenette for morning and afternoon tea service and a table for evening cocktail parties. With an uninterrupted view out to Albert Park, it is an ideal choice for a small, but significant gathering. Combine it with the hire of the East Terrace for an exclusive indoor-outdoor event of a much larger size.

---

Please note that the Members Lounge is only available for morning functions from 7–9.30am and evening functions from 5.30–10pm.

---

**Pax:**  
**Cocktail – 50**  
**Seated – 20**

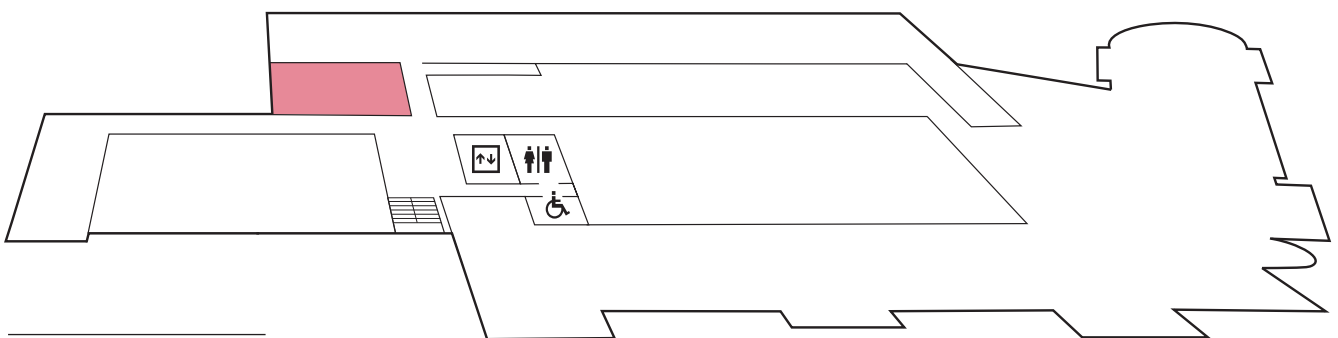

---

Level 2



# STRIKE A POSE FASHION FILMS

AUCKLAND  
ART GALLERY  
TOI OTAMAKI

m.  
members

SEEDLIP

DOCPLAY

ISTYLE



## Auditorium

Host your next lecture, film screening or seminar in our fit-for-purpose Auditorium. This theatre-style space is modern and elegant with state-of-the-art AV technology purpose-built for large screenings and illustrated talks. A separate entrance via our heritage clocktower enables you to host arrivals in a private foyer before entering the Auditorium, creating your own slice of Gallery experience. Combine its hire with our Lower Ground Boardroom right next door to enjoy a team day away in the art-and-culture centre of Auckland.

**Pax:**  
**Seated – 150**

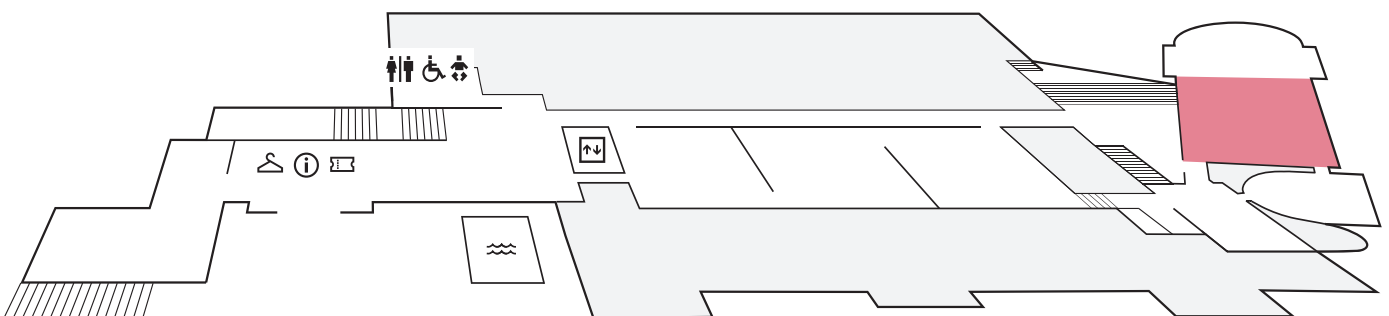





Lower Ground Boardroom and Foyer



## Lower Ground Boardroom and Foyer

Private, fit-for-purpose and with heritage-style architecture, book now for your next team away day. With the ability to create different seating styles, the Lower Ground Boardroom is a perfect choice for taking your team somewhere new and thinking more creatively. Now fitted with a new AV upgrade, the Boardroom can adapt to your business needs. Gather in the Foyer outside for refreshments and utilise our café, which can deliver morning teas, lunches and happy hour drinks to you as you work.

**Pax:**  
**Boardroom – 15**  
**Theatre – 30**

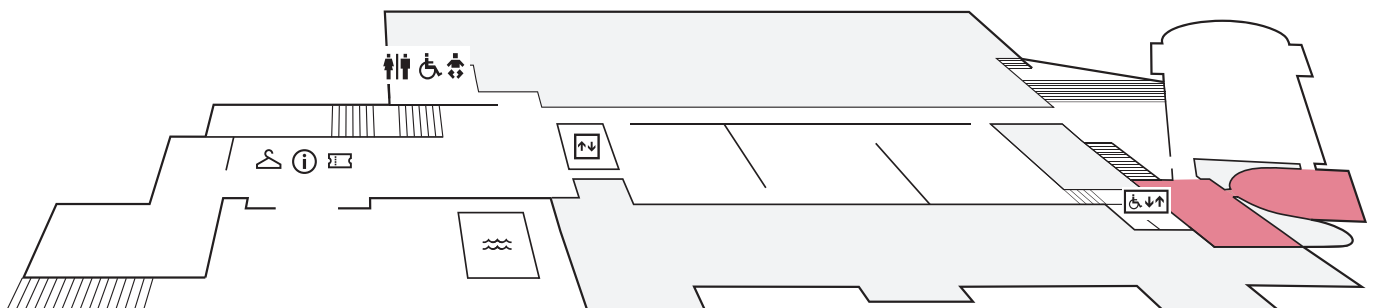





## Preferred suppliers

---

As a Gallery, our artwork taonga are our most important assets. We use our preferred caterers not only because they offer high levels of service and superior culinary skills, but also because they bring years of experience working alongside precious artworks. To make contact with our caterers for quotes, please make contact via our event coordinator.

---

### Partners



## Technical support

---

Technical support can be tailored to your needs and we support a wide variety of technical requirements. Auckland Live – the proven experts in providing top technical support – are our supplier for events. We work closely with them to perfect a response to your brief, whether for something small-and-sweet or out-of-this-world. They know our venue hire spaces best and contact with them is made via our event coordinator.



## **Location**

Corner Kitchener and Wellesley Streets

## **Contact**

Our event coordinator is here to answer all your questions and work alongside you and our suppliers to make your event at the Gallery come to life and exceed expectations.

## **Moira Russell**

Venue Hire and Events Coordinator

## **Phone**

**M** +64 27 453 1042

**DD** +64 9 890 2281

**T** +64 9 307 7700

## **Email**

[agrandevent@aucklandartgallery.com](mailto:agrandevent@aucklandartgallery.com)

**AUCKLAND  
ART GALLERY  
TOI OTĀMAKI**

[www.aucklandartgallery.com](http://www.aucklandartgallery.com)